

FREEMAN COMMERCIAL REAL ESTATE

Owner Wants to Close in 90 Days Former Copelands off Hanes Mall Boulevard Priced One Million Below Tax Value

8,000+/- Sq. Ft.
Restaurant

800 Sq. Ft. Patio

2.26+/- Acres

Price 1,599,000.00

110 Hanes Square Circle
Winston-Salem

Owner Wants to Sell
in 90 days



FREEMAN

COMMERCIAL REAL ESTATE
1255 Creekshire Way, Suite 200
Winston-Salem, NC 27103

FOR FURTHER INFORMATION
CONTACT:

LADD FREEMAN

PHONE: 336-768-4410

FAX: 336-768-4413

EMAIL:

LADD@FREEMANCOMMERCIAL.COM

Visit us on the Web

www.freemancommercial.com



NO WARRANTY OR REPRESENTATION IS MADE TO THE ACCURACY OF THE INFORMATION CONTAINED HEREIN. ALL INFORMATION IS SUBJECT TO CHANGE OR WITHDRAWAL. NO LIABILITY IS ASSUMED FOR ANY INACCURACY OF ANY INFORMATION.

FREEMAN COMMERCIAL REAL ESTATE

110 Hanes Square Circle
Winston-Salem, NC

Building Floor Plan

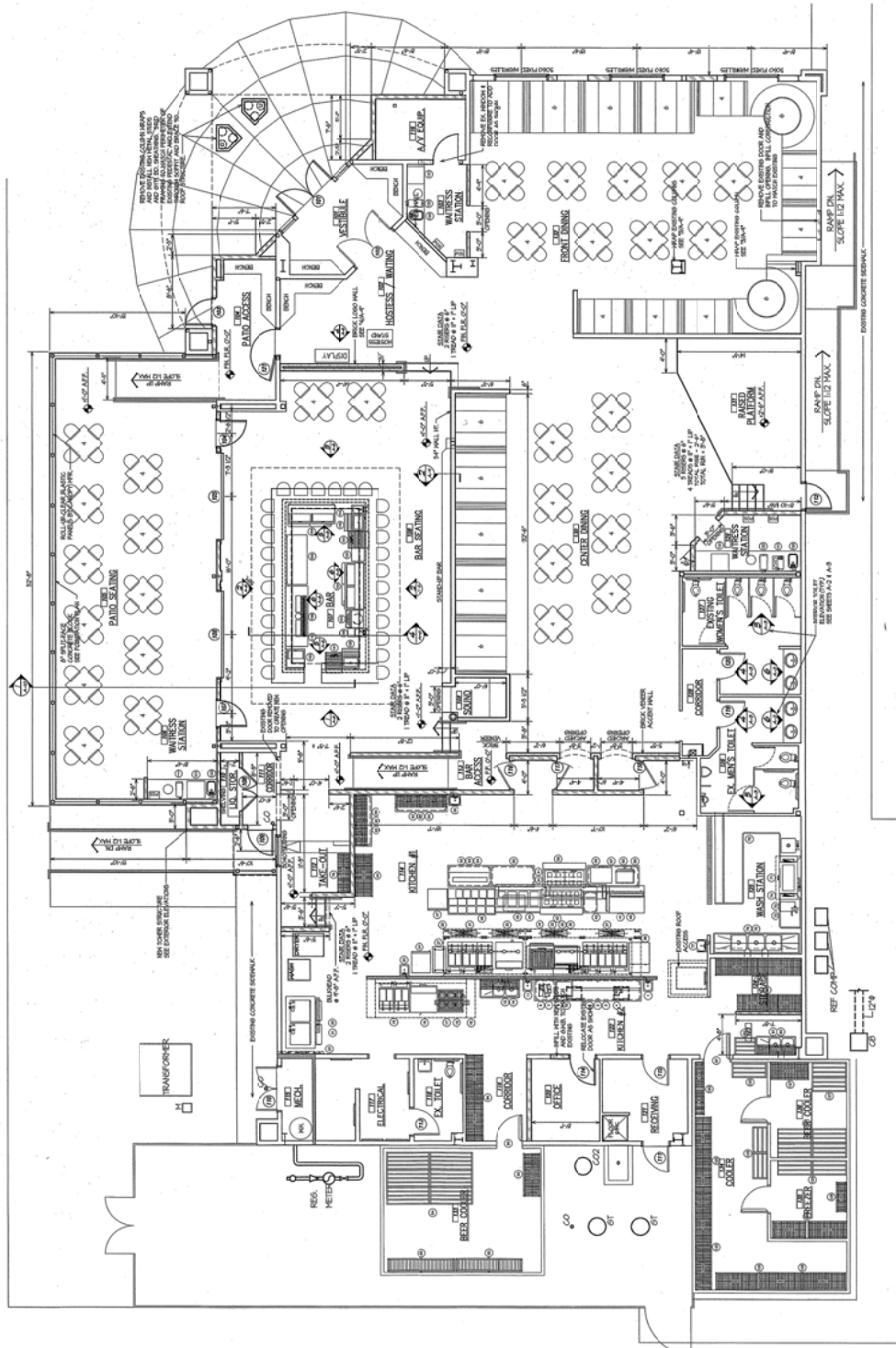

NO WARRANTY OR REPRESENTATION IS MADE TO THE ACCURACY OF THE INFORMATION CONTAINED HEREIN. ALL INFORMATION IS SUBJECT TO CHANGE OR WITHDRAWAL. NO LIABILITY IS ASSUMED FOR ANY INACCURACY OF ANY INFORMATION.